

Type 526

Flanged Safety Relief Valves
– spring loaded

Metric + US Units

M



Facts

LESER

The-Safety-Valve.com

Selection chart

	150 x 150	300L x 150	300 x 150	600 x 150	900 x 150	1500 x 150	2500 x 300
WCB	5262.580X	See 300 x 150	5262.581X	5262.582X	5262.583X	-	-
WC6	-	See 300 x 150	5267.584X	5267.585X	5267.586X	-	-

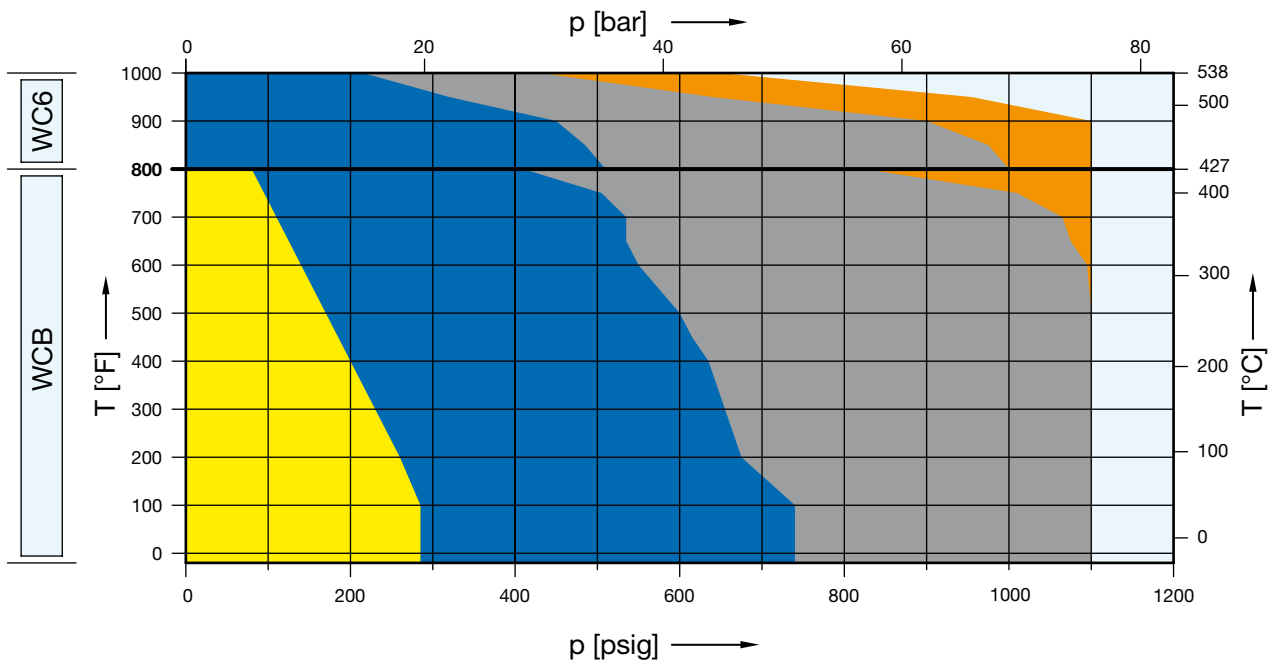

	150 x 150	300L x 150	300 x 150	600 x 150	900 x 150	1500 x 150	2500 x 300
CF8M	5264.587X	See 300 x 150	5264.588X	5264.589X	-	-	-

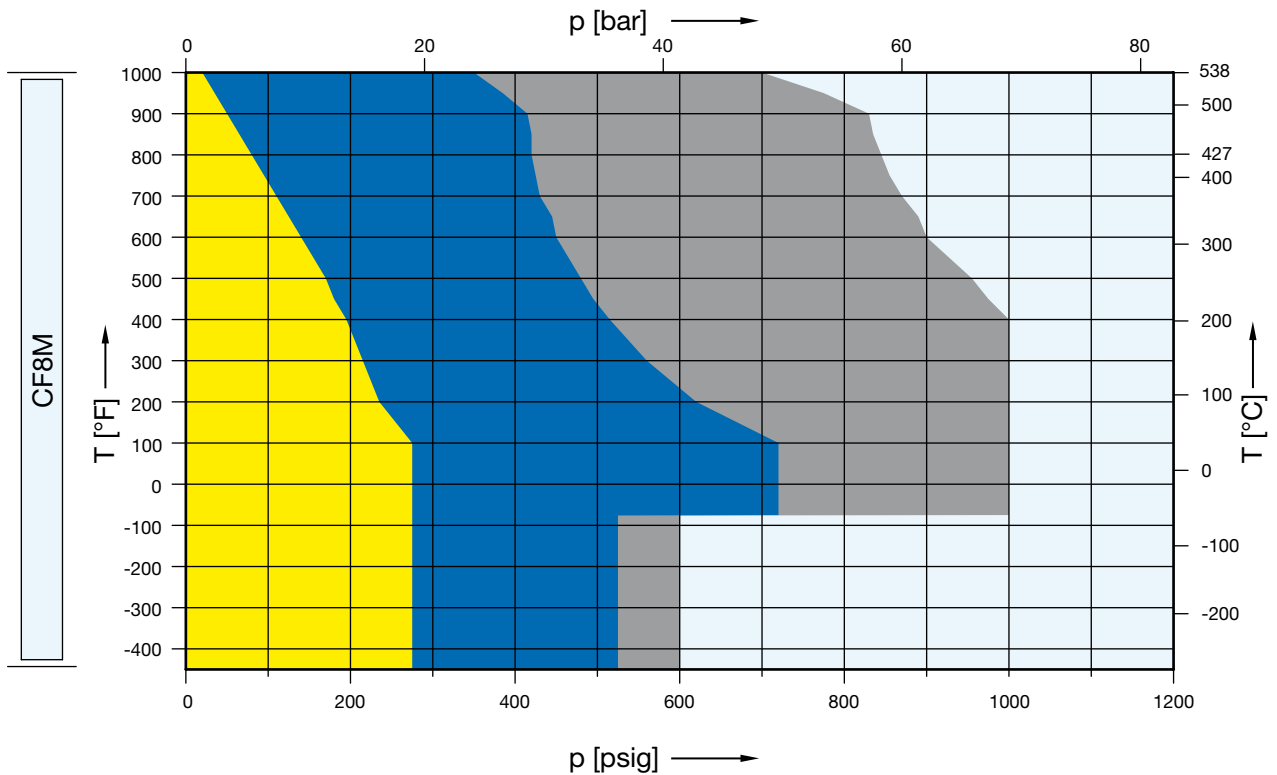

Article numbers, dimensions and weights

Article numbers

Valve size	4 M 6	4 M 6	4 M 6	4 M 6	4 M 6
Flange rating class $d_{inlet} \times d_{outlet}$	150 x 150	300L x 150	300 x 150	600 x 150	900 x 150
Actual Orifice diameter d_0 [mm]	60.3	60.3	60.3	60.3	60.3
Actual Orifice area A_0 [mm ²]	2856	2856	2856	2856	2856

Body material

WCB 1.0619	Art.-No.	5262.580 [□]	Use 4 M 6 300 x 150	5262.581 [□]	5262.582 [□]	5262.583 [□]
CF8M 1.4408	Art.-No.	5264.587 [□]		5264.588 [□]	5264.589 [□]	-
WC6 1.7357	Art.-No.	-		5267.584 [□]	5267.585 [□]	5267.586 [□]
LCB	Art.-No.	5263.546 [□]		5263.547 [□]	5263.548 [□]	5263.549 [□]

[□] Please add code for the required cap or lifting device. See below.

Dimensions and weights

Metric Units

Weight [kg]		112.1	Use 4 M 6 300 x 150	112.1	122	134.1
	with bellows	118.7		118.7	128.6	140.7
Center to face [mm]	Inlet a	178		178	178	197
	Outlet b	184		184	203	222
	s	48		48	56	72
Height (H4) [mm]	Standard H max.	852	852	852	871	
	Bellows H max.	885	885	885	904	
Support brackets [mm]	A	278	278	278	278	
	B	160	160	160	160	
	C	Ø 18	Ø 18	Ø 18	Ø 18	
	D	260	260	260	280	
	E	25	25	25	25	

US Units

Weight [lbs]		247.2	Use 4 M 6 300 x 150	247.2	269	295.7
	with bellows	261.7		261.7	283.6	310.2
Center to face [inch]	Inlet a	7		7	7	7 ³ / ₄
	Outlet b	7 ¹ / ₄		7 ¹ / ₄	8	8 ³ / ₄
	s	1 ⁷ / ₈		1 ⁷ / ₈	2 ³ / ₁₆	2 ³ / ₄
Height (H4) [inch]	Standard H max.	33 ¹⁷ / ₃₂	33 ¹⁷ / ₃₂	33 ¹⁷ / ₃₂	33 ¹⁷ / ₃₂	
	Bellows H max.	34 ²⁷ / ₃₂	34 ²⁷ / ₃₂	34 ²⁷ / ₃₂	34 ²⁷ / ₃₂	
Support brackets [inch]	A	10 ¹⁵ / ₁₆	10 ¹⁵ / ₁₆	10 ¹⁵ / ₁₆	10 ¹⁵ / ₁₆	
	B	6 ⁵ / ₁₆	6 ⁵ / ₁₆	6 ⁵ / ₁₆	6 ⁵ / ₁₆	
	C	Ø ²³ / ₃₂	Ø ²³ / ₃₂	Ø ²³ / ₃₂	Ø ²³ / ₃₂	
	D	10 ¹ / ₄	10 ¹ / ₄	10 ¹ / ₄	11	
	E	³ / ₃₂	³ / ₃₂	³ / ₃₂	³ / ₃₂	

Code for lifting device

Lifting device	H2	H3	H4	H3
Bonnet	closed	closed	closed	open
WCB 1.0619, WC6 1.7357, LCB	2	3	4	5
CF8M 1.4408	2	-	4	-

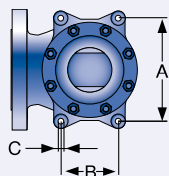

Support brackets

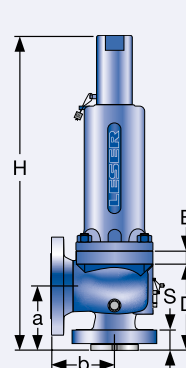

Conventional design

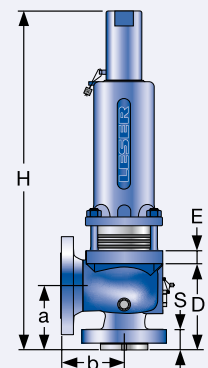

Balanced bellows design

Pressure temperature ratings

Metric Units						
Valve size		4 M 6	4 M 6	4 M 6	4 M 6	4 M 6
Flange rating class <small>Inlet x Outlet</small>		150 x 150	300L x 150	300 x 150	600 x 150	900 x 150
Actual Orifice diameter d_0 [mm]		60.3	60.3	60.3	60.3	60.3
Actual Orifice area A_0 [mm ²]		2846	2846	2846	2846	2846
Minimum set pressure [bar] S/G/L		0.2	0.2	0.2	0.2	0.2
Minimum set pressure [bar] S/G		2.6	2.6	2.6	6.3	10.5
Balanced bellows Inconel [bar] L		2.2	2.2	2.2	10.5	10.5
Body material: WCB 1.0619		Pressure range p [bar] S/G/L				
Maximum set pressure	-29 to 38 °C	19.7	Use 4 M 6 300 x 150	51.0	75.9	75.9
	39 to 232 °C	12.8		42.4	75.9	75.9
	233 to 427 °C	5.5		28.3	56.9	75.9
Outlet pressure limit Conventional design		19.7		19.7	19.7	19.7
Outlet pressure limit Balanced bellows design		5.5		11.0	11.0	11.0
Body material: CF8M 1.4408		Pressure range p [bar] S/G/L				
Maximum set pressure	-268 to -60 °C	19.0	Use 4 M 6 300 x 150	36.2	41.4	-
	-59 to -29 °C	19.0		49.7	69.0	-
	-28 to 38 °C	19.0		49.7	69.0	-
	39 to 232 °C	12.4		34.1	67.2	-
	233 to 427 °C	5.5		29.0	58.3	-
	428 to 538 °C	1.4		24.1	48.3	-
Outlet pressure limit Conventional design		19.0		19.0	19.0	-
Outlet pressure limit Balanced bellows design		5.5		11.0	11.0	-
Body material: WC6 1.7357		Pressure range p [bar] S/G/L				
Maximum set pressure	233 to 427 °C	-	Use 4 M 6 300 x 150	35.2	69.0	75.9
	428 to 538 °C	-		14.8	29.7	44.8
Outlet pressure limit Conventional design		-		19.7	19.7	19.7
Outlet pressure limit Balanced bellows design		-		11.0	11.0	11.0
Body material: LCB		Pressure range p [bar] S/G/L				
Maximum set pressure	-46 to 38 °C	18.4	Use 4 M 6 300 x 150	48.0	75.9	75.9
	39 to 200 °C	13.8		42.5	75.9	75.9
	201 to 343 °C	8.4		36.4	72.8	75.9
Outlet pressure limit Conventional design		18.4		18.4	18.4	18.4
Outlet pressure limit Balanced bellows design		5.5		11.0	11.0	11.0

Remark: SA 352 Gr. LCB is not listed in the API 526. Pressure-Temperature Rating acc. to ASME B16.34 Table 2-1.3
The stated Pressure-Temperature Rating are taken from ASME B16.34 Table 2-1.3 if the maximum pressure is not limited by API 526.

Due to the extended material test certificate the LESER LCB can be applied as LCC, WCB, WCC and 1.0619 with the respective pressure-temperature range as well.

Pressure temperature ratings

US Units						
Valve size		4 M 6	4 M 6	4 M 6	4 M 6	4 M 6
Flange rating class <small>Inlet x Outlet</small>		150 x 150	300L x 150	300 x 150	600 x 150	900 x 150
Actual Orifice diameter d_0 [inch]		2.37	2.37	2.37	2.37	2.37
Actual Orifice area A_0 [inch ²]		4.43	4.43	4.43	4.43	4.43
Minimum set pressure [psig] S/G/L		3.0	3.0	3.0	3.0	3.0
Minimum set pressure [psig] S/G		37.7	37.7	37.7	91.4	152.3
Balanced bellows Inconel [psig] L		31.9	31.9	31.9	152.3	152.3
Body material: WCB 1.0619		Pressure range p [psig] S/G/L				
Maximum set pressure	-20 to 100 °F	285	Use 4 M 6 300 x 150	740	1100	1100
	101 to 450 °F	185		615	1100	1100
	451 to 800 °F	80		410	825	1100
Outlet pressure limit Conventional design		285		285	285	285
Outlet pressure limit Balanced bellows design		80		160	160	160
Body material: CF8M 1.4408		Pressure range p [psig] S/G/L				
Maximum set pressure	-450 to -76 °F	275	Use 4 M 6 300 x 150	525	600	-
	-75 to -21 °F	275		720	1000	-
	-20 to 100 °F	275		720	1000	-
	101 to 450 °F	180		495	975	-
	451 to 800 °F	80		420	845	-
801 to 1000 °F	20	350	700	-		
Outlet pressure limit Conventional design		275		275	275	-
Outlet pressure limit Balanced bellows design		80		160	160	-
Body material: WC6 1.7357		Pressure range p [psig] S/G/L				
Maximum set pressure	451 to 800 °F	-	Use 4 M 6 300 x 150	510	1000	1100
	801 to 1000 °F	-		215	430	650
Outlet pressure limit Conventional design		-		285	285	285
Outlet pressure limit Balanced bellows design		-		160	160	160
Body material: LCB		Pressure range p [psig] S/G/L				
Maximum set pressure	-50 to 100 °F	265	Use 4 M 6 300 x 150	695	1100	1100
	101 to 400 °F	200		615	1100	1100
	401 to 650 °F	125		535	1065	1100
Outlet pressure limit Conventional design		265		265	265	265
Outlet pressure limit Balanced bellows design		80		160	160	160

Remark: SA 352 Gr. LCB is not listed in the API 526. Pressure-Temperature Rating acc. to ASME B16.34 Table 2-1.3
The stated Pressure-Temperature Rating are taken from ASME B16.34 Table 2-1.3 if the maximum pressure is not limited by API 526.

Due to the extended material test certificate the LESER LCB can be applied as LCC, WCB, WCC and 1.0619 with the respective pressure-temperature range as well.